



LETTINGS | SALES | PROPERTY MANAGEMENT



119 Tequila Wharf, Canary Wharf,  
London, E14 7LH

**£1,750.00**  
Per month



119 Tequila Wharf, Canary Wharf,  
London, E14 7LH

**£1,750.00**  
Per month

This bright and spacious one bedroom apartment is in a modern development in Limehouse E14. The apartment comes furnished, a private balcony overlooking the Limehouse Canal, concierge and good sized bedroom. The EPC rating is B, with good insulation and gas heating. The kitchen comes with all fully integrated appliances and leads into the bright open plan living area. The apartment is West / North West facing so benefits from evening light after a hard days work.

## DESCRIPTION



1 Bedrooms



1 Bathrooms



1 Reception

Council Tax: **C**

Available Date: -

Furnishing Status: **Furnished**

Deposit: **£2,019.23**

Nearest Station (inc. distance):

- Limehouse, 0.2M

## FEATURES

- Concierge
- Balcony
- Canal view
- Gated development
- Close to Limehouse DLR



## FLOOR PLANS

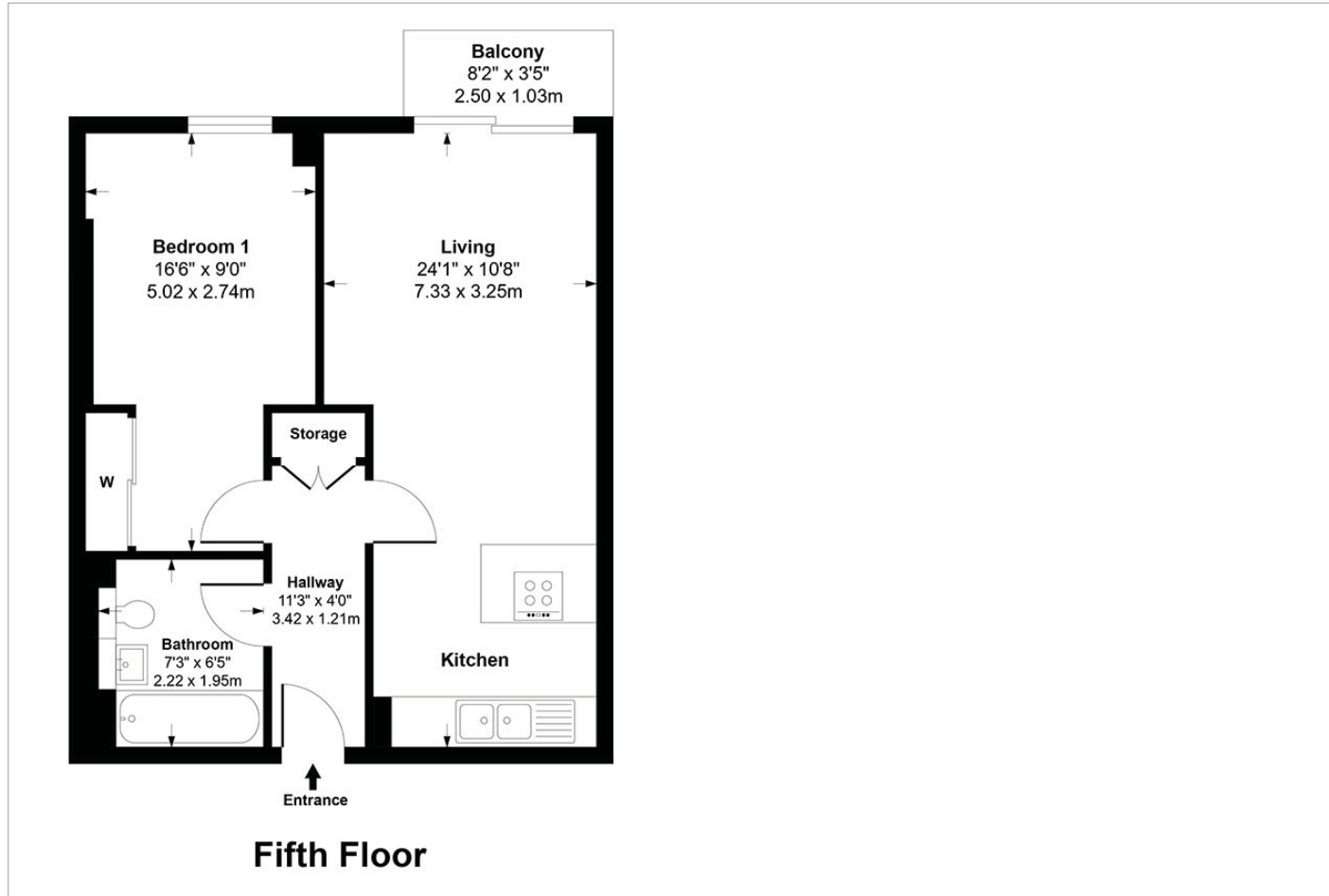

These particulars, whilst believed to be accurate are set out as a general outline only for guidance and do not constitute any part of an offer or contract. Intending purchasers should not rely on them as statements of representation of fact, but must satisfy themselves by inspection or otherwise as to their accuracy. No person in this firm's employment has the authority to make or give any representation or warranty in respect of the property.

## AREA MAP

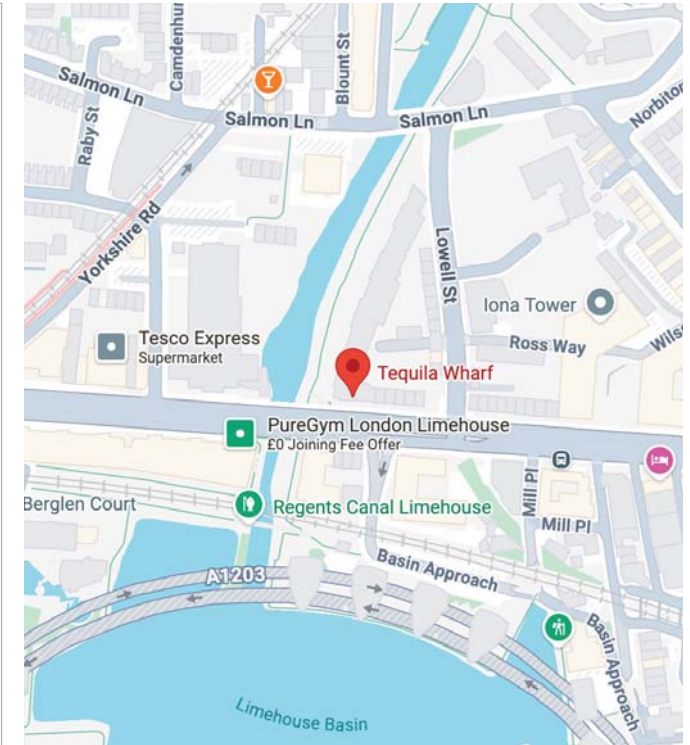

## ENERGY PERFORMANCE GRAPH

